



## S2320 Series 300 Watts

## AC/DC Switching Power Supply

With Active PFC



Dimension : L 214 W 115 xH 50mm

### FEATURES

- High Reliability
- 100% Full Load BURN-IN Tested
- 100% Hi-Pot tested
- Safety Approvals, EMC compliance
- Cooling fan with On/Off auto control

### ELECTRICAL SPECIFICATIONS

- Input Voltage : 88-264VAC (Full Range)
- Frequency : 47 - 63Hz
- Power factor : >0.98@115 VAC;>.95@230VAC
- Inrush current : Cold Start, 25A 115 VAC; 50 A 230 VAC MAX
- Output Voltage Range :  $\pm 10\%$  Rated Output Voltage
- Voltage regulation :  $\leq 0.5\%$
- Maximum power (Po) : 250W
- Ripple & Noise : 1%
- Hold-up time : >50ms; 20ms Typical at full load @ 115VAC
- Protection : Over voltage protection(OVP), 105%-145%  
Short circuit protection, Auto recovery

### SAFETY STANDARDS

- UL 60950
- CSA C22.2 No.60950-1
- TUV EN60950-1
- CB IEC 60950-1

### EMI STANDARDS

- FCC Class B
- CISPR22 Class B
- EN 55022 Class B
- C E

### ENVIRONMENTAL

- Operating temperature : -10°C to +50°C @100%; -20°C@80%; +65°C @ 50 % Load
- Storage temperature : -40°C to +85°C

### DC OUTPUT & FEATURES

Model	Output Rating		Po(Max.)	Load Regulation	Ripple & Noise (Vp-p)	Efficiency
	Vo	Io (max)				
S2320-3.3	3.3V	55A	180W	1.5%	100mV	74%
S2320-5.0	5.0V	55A	275W	1.0%	100mV	79%
S2320-7.5	7.5V	40A	300W	1.0%	100mV	83%
S2320-12	12V	25A	300W	0.5%	120mV	83%
S2320-13.5	13.5V	22A	300W	0.5%	120mV	86%
S2320-15	15V	20A	300W	0.5%	150mV	86%
S2320-24	24V	13A	300W	0.5%	150mV	87%
S2320-27	27V	11.7A	315W	0.5%	150mV	88%
S2320-48	48V	6.7A	320W	0.5%	200mV	89%

**Note:** 1. Ripple and Noise are measured at oscilloscope 20MHz bandwidth with a electrolytic 10uF and 0.1uF ceramic capacitor in parallel at the output connector.



### SMP TECHNOLOGY, INC.

5900 Butler Lane, Scotts Valley, CA 95066

Tel : (831) 440-9191 Fax : (831) 427-7570

<http://www.smp-tech.com>

E-Mail : [sales@smp-tech.com](mailto:sales@smp-tech.com)

**AC/DC Switching Power Supply**

**MECHANICAL SPECIFICATION**

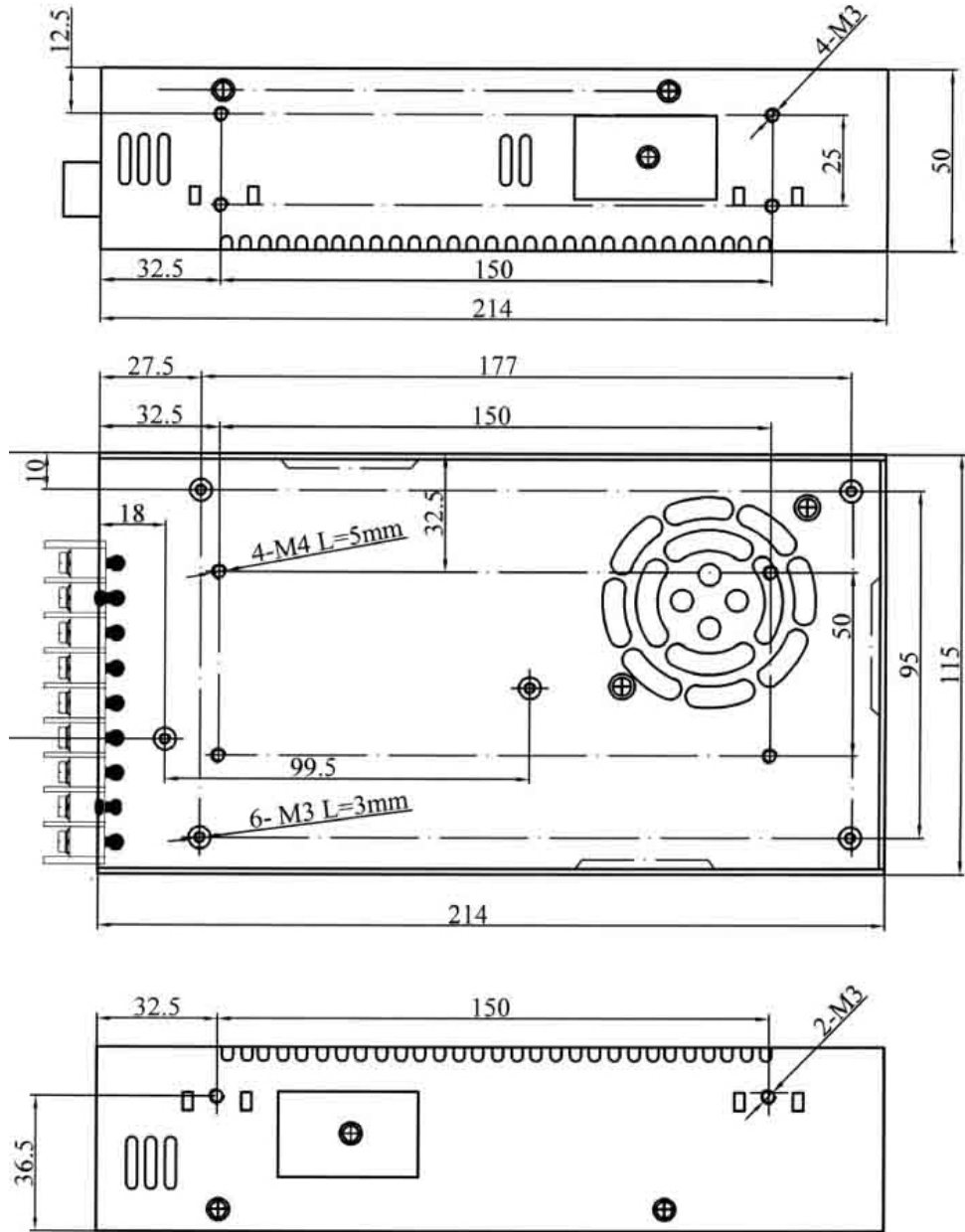

**SMP TECHNOLOGY, INC.**

227 Technology Circle, Scotts Valley, CA 95066

Tel : (831) 440-9191 Fax : (831) 440-9195

http : //www.smp-tech.com

E-Mail : sales@smp-tech.com