

Specifications:	PSU40 Series:
Input voltage	100~240 VAC (Limits:90-264VAC)
Input frequency	50 ~ 60Hz (Limits : 47 ~ 63 Hz)
Input current	1.0A Max.
Safety ground leakage current	Class1 : 3.5mA / Class 2 : 0.25mA Max. @ 240 VAC 50HZ
Output voltage	See rating chart
Output current	See rating chart
Output power range	40 watts Max.
Ripple	1% peak to peak maximum
Over voltage protection	Provided on outputs set at 112~132% of its nominal output voltage
Over current protection	All outputs protected to short circuit conditions
Temperature coefficient	All outputs $\pm 0.04\%$ / °C maximum
Transient response	Maximum excursion of 4% or better on all models. Recovering to 1% of final value within 500uS after a 25% step load change
Operating temperature	0°C~+40°C See derating curve
Storage temperature	-40°C to +85°C
Relative humidity	5% to 95% non-condensing
Derating	Derated from 100% at +40°C linearly to 70% at 50°C
Efficiency	See rating chart
Hold-up time	10 msec minimum
Line regulation	$\pm 1\%$ maximum for any input voltage change between input voltage range
Load regulation	$\pm 5\%$ variations from minimum to maximum output current.
Insulation resistance	50 Mohm minimum from output to ground
Inrush current	15 AMPS @ 115 VAC, or 30 AMPS @ 230 VAC at 25 °C cold start
Withstand voltage	4242VDC from input to output
Mean time between failure	50,000 hours minimum at full load at 25°C ambient
EMI requirements	Meet CE standards
Safety requirements	Meets or exceeds:(A)UL 1950 (B) CSA C22.2 (C)TUV EN60950-1 (D) IEC 950
Warranty	1 year

USA VERSION
(OPTIONAL)

UNIT: mm

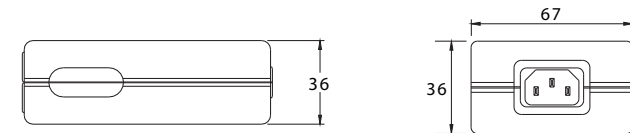
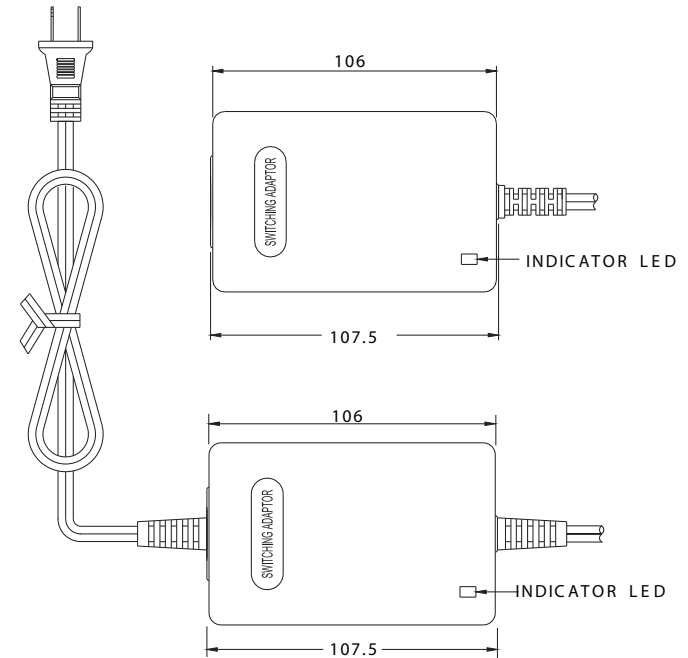

FIG 1

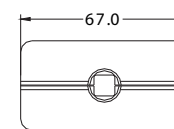

FIG 2

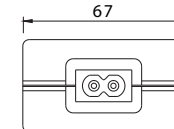

FIG 3



SMP TECHNOLOGY, INC.

DESKTOP SWITCHING POWER SUPPLY, 15 - 40 WATT,

VENTLESS, UNIVERSAL INPUT VOLTAGE, OPTIONAL INPUT INLETS

SERIES:PSU40

Pg: 1

STRAIGHT

MALE PLUG STRAIGHT (parallel cord)

	Part Number	D +/-0.1		L+/-0.5	Wire Gauge
	SM1A	ø2.5		11	#22 #24
	SM2A	ø3.5		14	#22 #24

MALE PLUG STRAIGHT (parallel/coaxial cord)

	Part Number	D +/-0.1		L+/-0.5	Wire Gauge
	SM2B	ø3.5		14	#22 #24

FEMALE PLUG STRAIGHT (parallel cord)

	Part Number	D +/-0.1	d+/-0.1	L+/-0.5	Wire Gauge
	SF2A	ø3.5	ø1.3	7	#22 #24
	SF2B	ø3.5	ø1.3	9.5	#22 #24
	SF2C	ø3.5	ø1.3	11	#22 #24
	SF2D	ø3.5	ø1.3	14	#22 #24
	SF3A	ø5.0	ø2.1	9.5	#20
	SF3B	ø5.0	ø2.1	11	#20
	SF3C	ø5.0	ø2.1	14	#20
	SF5C	ø5.5	ø2.5	9.5	#18,#20
	SF5B	ø5.5	ø2.5	11	#18,#20
SF5A	ø5.5	ø2.5	14	#18,#20	
SF6A	ø6.5	ø3.0	9.5	#20	
SF6B	ø6.5	ø3.0	11	#20	

FEMALE PLUG STRAIGHT (parallel cord)

	Part Number	D +/-0.1	d+/-0.1	L+/-0.5	Wire Gauge
	SF3D	ø5.0	ø2.1	9.5	#22 #24
	SF3E	ø5.5	ø2.1	11	#22 #24
	SF5D	ø5.5	ø2.1	9.5	#22 #24
SF5E	ø5.5	ø2.5	11	#22 #24	

FEMALE PLUG STRAIGHT (parallel cord #20,#22,#24 /Coaxial #22)

	Part Number	D +/-0.1	d+/-0.1	L+/-0.5	Wire Gauge
	SF5F	ø5.5	ø2.1	9.5	#20,#22,#23
	SF5G	ø5.5	ø2.1	11	#20,#22,#23
	SF5H	ø5.5	ø2.5	9.5	#20,#22,#23
SF5I	ø5.5	ø2.5	11	#20,#22,#23	

FEMALE PLUG STRAIGHT (SPT-1#18 & XTW-A #20 Cord)

	Part Number	D +/-0.1	d+/-0.1	L+/-0.5	Wire Gauge
SF5J	ø5.5	ø2.1	12.5	#18,#20	

FEMALE PLUG STRAIGHT (parallel/coaxial cord)

	Part Number	D +/-0.1	d+/-0.1	L+/-0.5	Wire Gauge
	SF5K	ø5.5	ø2.1	9.5	#22 #24
	SF5L	ø5.5	ø2.1	11	#22 #24
	SF5M	ø5.5	ø2.1	14	#22 #24
SF5N	ø5.5	ø2.5	11	#22 #24	

MINI DIN MALE PLUG, STRAIGHT

	Part Number	Pin Configuration
	SMD3	
	SMD4	
	SMD5	
	SMS5	
	SMD6	
	SMD7	

RIGHT ANGLE

FEMALE PLUG RIGHT ANGLE (parallel cord)

	Part Number	D +/-0.1	d+/-0.1	L+/-0.5	Wire Gauge
	RF4A	ø5.03	ø1.57	8.2	#22 #24
	RF4B	ø5.03	ø1.57	13.5	#22 #24
	RF3A	ø5.0	ø2.1	9	#22 #24
	RF3B	ø5.0	ø2.1	11	#22 #24
	RF3C	ø5.0	ø2.5	11	#22 #24
	RF5A	ø5.5	ø1.3	11	#22 #24
	RF5B	ø5.5	ø2.1	9.5	#22 #24
	RF5C	ø5.5	ø2.5	9.5	#22 #24
	RF5D	ø5.5	ø2.1	11	#22 #24
RF5E	ø5.5	ø2.5	11	#22 #24	

FEMALE PLUG RIGHT ANGLE (parallel cord)

	Part Number	D +/-0.1	d+/-0.1	L+/-0.5	Wire Gauge
	RF2A	ø3.5	ø1.3	9	#22 #24
	RF2B	ø3.5	ø1.3	11	#22 #24
	RF5F	ø5.5	ø2.1	9.5	#22 #24
	RF5G	ø5.5	ø2.1	11	#22 #24
	RF5H	ø5.5	ø2.5	9.5	#22 #24
RF5I	ø5.5	ø2.5	11	#22 #24	

FEMALE PLUG RIGHT ANGLE (Coaxial cord)

	Part Number	D +/-0.1	d+/-0.1	L+/-0.5	Wire Gauge
	RF5J	ø5.5	ø2.1	9.5	#22 #24
	RF5K	ø5.5	ø2.1	11	#22 #24
	RF5L	ø5.5	ø2.5	9.5	#22 #24
RF5M	ø5.5	ø2.5	11	#22 #24	

MALE/FEMALE PLUG RIGHT ANGLE (Parallel cord)

	Part Number	D +/-0.1		L+/-0.5	Wire Gauge
RM2A	ø3.5		16.5	#22 #24	

MINI DIN MALE PLUG, RIGHT ANGLE

	Part Number	Pin Configuration
	RMD3	
	RMD4	
	RMD5	
	RMS5	
	RMD6	
	RMD7	

OUTPUT PLUG TABLE