

P.C.B LAYOUT

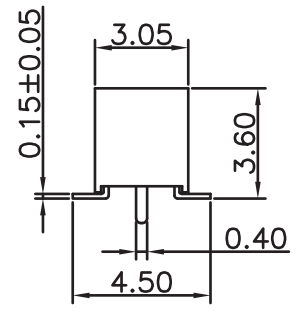
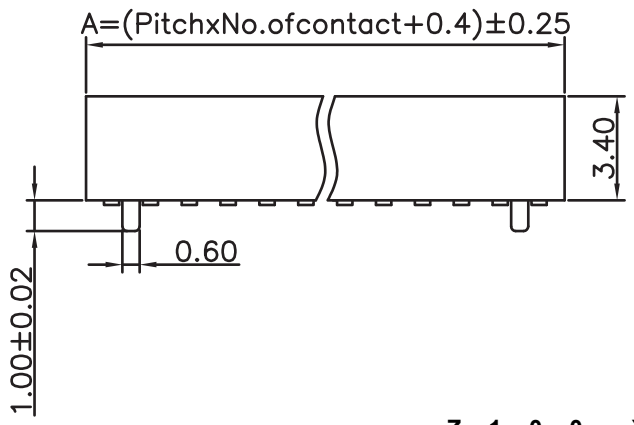

ELECTRICAL:

CURRENT RATING: 1A
 CONTACT RESISTANCE:
 <30 Milliohm Max
 INSULATION RESISTANCE:
 >5000 Megaohm Min
 DIELECTRIC WITHSTANDING VOLTAGE:
 600V (RMS) AC for 1 Minute
 OPERATING TEMPERATURE: -40°C to +105°C

MATERIAL:

INSULATOR: LCP
 CONTACT: Phosphor Bronze

MATERIAL:

DURABILITY: 50 Cycles
 RETENTION FORCE: 300g Min
 INSERTION FORCE: 56g
 SOLDERABILITY: Per MIL-STD-202F Method 208D
 MAX. PROCESSING TEMPERATURE: 260°C for 10 seconds

Z 1 0 0 - X X 0 8 - 4 2 X X - Z

NO OF POSITIONS

06-98
 A0=100

TYPE

08 - Surface Mount, No Polarization,
 Double Row, No Mounting Ears

PACKAGING

- 1 - In Tube
- 2 - With Cap In Tube
- 3 - With Film In Tube
- 4 - With Cap; Tape & Reel
- 5 - With Film; Tape & Reel

RoHS COMPLIANT

CONTACT PLATING

Full Gold Selective Gold

- 1 - Gold Flash 6 - Gold Flash
- 3 - 10u" Gold 7 - 10u" Gold
- 4 - 15u" Gold 8 - 15u" Gold
- 5 - 30u" Gold 9 - 30u" Gold

Rev		Drawn	Checked	Approved	Date
0	Issued	B.S.	S.M.	S.M.	9/28/07

SMP TECHNOLOGY, INC.

Receptacle Assembly, 1.27mm x 1.27mm, Surface Mount,

SCALE 3.6 mm Height with Mounting Posts

TOL. DEC. .X +/- 0.3 .XX +/- 0.2 .XXX +/- 0.1 ANGLE +/- 5° UNIT: mm

P/N: Z100-XX08-42XX-Z