

HOW TO ORDER:

W 0 2 6 - 1 0 0 0 - 0 0 X

Female Receptacle

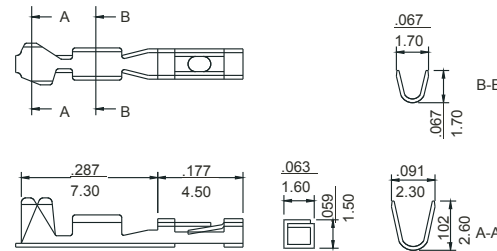

HOW TO ORDER:

W 0 2 6 - 2 0 0 0 - 0 0 X

Male Pin

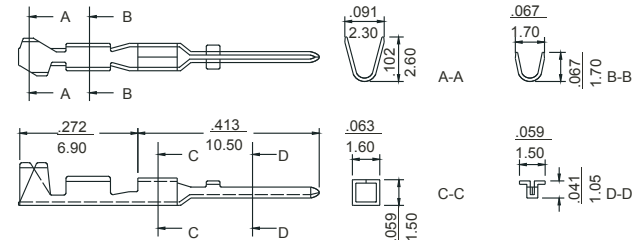

PLATING:

- 1 - Tin Plated
- 2 - Au Flash
- 3 - 10µ" Gold
- 4 - 30µ" Gold

Dimensional information - inch/mm

Circuits	Dim. A		Dim. B		Circuits	Dim. A		Dim. B		Circuits	Dim. A		Dim. B	
	inch	mm	inch	mm		inch	mm	inch	mm		inch	mm	inch	mm
4	0.100	2.54	0.200	5.08	30	1.400	35.56	1.500	38.10	56	2.700	68.58	2.800	71.12
6	0.200	5.08	0.300	7.62	32	1.500	38.10	1.600	40.64	58	2.800	71.12	2.900	73.66
8	0.300	7.62	0.400	10.16	34	1.600	40.64	1.700	43.18	60	2.900	73.66	3.000	76.20
10	0.400	10.16	0.500	12.70	36	1.700	43.18	1.800	45.72	62	3.000	76.20	3.100	78.74
12	0.500	12.70	0.600	15.24	38	1.800	45.72	1.900	48.26	64	3.100	78.74	3.200	81.28
14	0.600	15.24	0.700	17.78	40	1.900	48.26	2.000	50.80	66	3.200	81.28	3.300	83.82
16	0.700	17.78	0.800	20.32	42	2.000	50.80	2.100	53.34	68	3.300	83.82	3.400	86.36
18	0.800	20.32	0.900	22.86	44	2.100	53.34	2.200	55.88	70	3.400	86.36	3.500	88.90
20	0.900	22.86	1.000	25.40	46	2.200	55.88	2.300	58.42	72	3.500	88.90	3.600	91.44
22	1.000	25.40	1.100	27.94	48	2.300	58.42	2.400	60.96	74	3.600	91.44	3.700	93.98
24	1.100	27.94	1.200	30.48	50	2.400	60.96	2.500	63.50	76	3.700	93.98	3.800	96.52
26	1.200	30.48	1.300	33.02	52	2.500	63.50	2.600	66.04	78	3.800	96.52	3.900	99.06
28	1.300	33.02	1.400	35.56	54	2.600	66.04	2.700	68.58	80	3.900	99.06	4.000	101.60

ELECTRICAL:

CURRENT RATING: 1A AC/DC
VOLTAGE RATING: 125V AC/DC

MATERIAL:

CONTACT: Copper Alloy
APPLICABLE WIRE: AWG #28 - #22
BASE: Nylon UL94V-0
STANDARD COLOR: Black

HOW TO ORDER:

W 0 2 5 - X X 2 X - 0 0 0 - Z

OF POSITIONS:

4 - 80

NUMBER OF ROWS:

- 1 - Single Row
- 2 - Double Row

POLARIZING KEY:

- 0 - w/Center Polarizing Notch
- 1 - w/OUT Center Polarizing Notch

RoHS COMPLIANT

Rev	Drawn	Checked	Approved	Date
0 Issued	A.M.	S.M.	S.M.	02/13/04
A Revised for RoHS Compliance	B.S.	S.M.	S.M.	08/04/08

SMP TECHNOLOGY, INC.

2.54mm Pitch, Single Row Crimp Terminal Housing