

Recommened PCB Layout

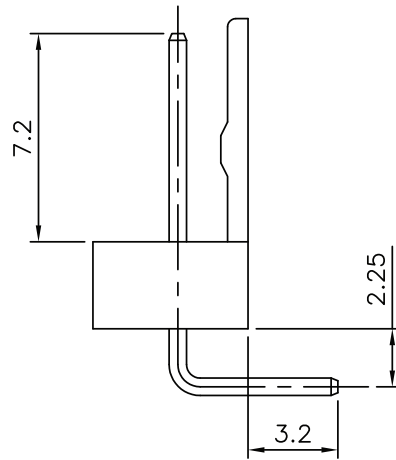
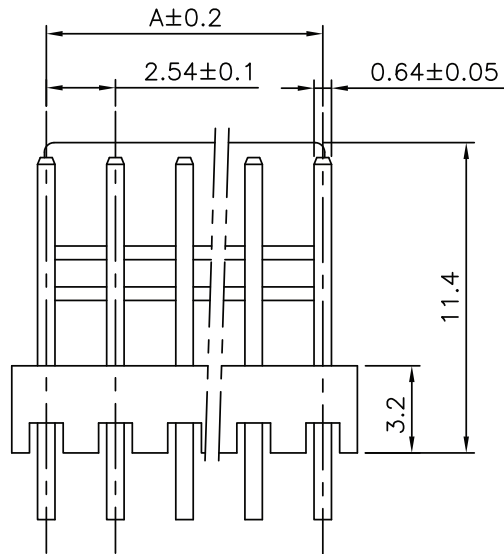

# of Contacts	Dimensions(mm)	
	A	B
2	2.54	5.08
3	5.08	7.62
4	7.62	10.16
5	10.16	12.70
6	12.70	15.24
7	15.24	17.78
8	17.78	20.32
9	20.32	22.86
10	22.86	25.40
11	25.40	27.94
12	27.94	30.48
13	30.48	33.02
14	33.02	35.56
15	35.56	38.10

ELECTRICAL:

CURRENT RATING: 3A AC, DC
 VOLTAGE RATING: 250V AC MAX.
 OPERATING TEMPERATURE: -25 ° TO +85 °C
 CONTACT RESISTANCE: 20 MILLIOHM MAX.
 INSULATION RESISTANCE: 1000 MEGAOHM MIN.
 VOLTAGE WITHSTANDING: 1000V AC / MINUTE

MATERIAL:

CONTACT MATERIAL: COPPER ALLOY, TIN PLATED
 WAFER MATERIAL: NYLON 6/6 UL 94V-2
 PACKAGING: 1,000 Pcs/ Bag

HOW TO ORDER:

W 0 1 9 - X X 0 2 - 1 2 X - Z

NUMBER OF CONTACTS:
02THRU15

CONTACT PLATING

- 1-TINPLATED
- 2-GOLDFLASH
- 3-10u"GOLD
- 5-30u"GOLD

RoHS COMPLIANT

Rev	Drawn	Checked	Approved	Date
0	B.S.	S.M.	S.M.	5/31/07

SMP TECHNOLOGY, INC.

2.54mm Pitch, Right Angle, Locking Type

SCALE: N/A

TOL. DEC. .X +/- 0.3 .XX +/- 0.2 .XXX +/- 0.1 ANGLE +/- UNIT: mm

SERIES: W019-XX02-12X-Z