

ISOMETRIC VIEW

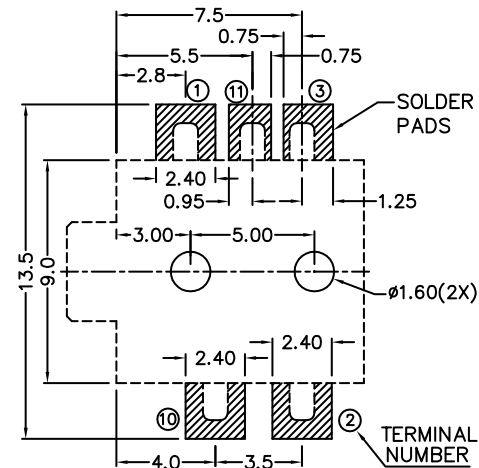
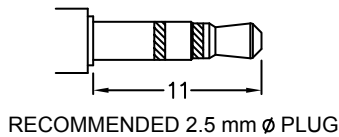
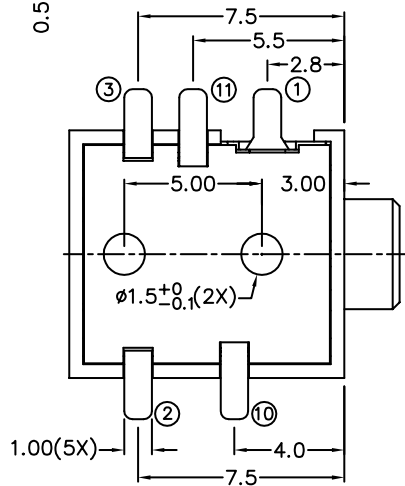
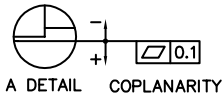

RECOMMENDED PCB LAYOUT

ELECTRICAL:

CURRENT: 0.5A
 CONTACT RESISTANCE: < 50m
 INSULATOR RESISTANCE: > 100M
 DIELECTRIC WITHSTANDING VOLTAGE: 500VAC FOR 1 MIN.

MATERIAL:

INSULATOR: PA6T : UL 94V-0
 BUSHING: NICKEL PLATED BRASS
 CONTACT SPRINGS: PHOSPHOR BRONZE
 SHUNT TERMINALS: TIN PLATED BRASS
 GROUND TERMINALS: TIN PLATED BRASS

MODEL NO.	S713-0312-120-Z	S713-0322-120-Z	S713-0332-120-Z	S713-0342-120-Z	S713-0352-120-Z	S713-0362-120-Z
SCHEMATIC						

HOW TO ORDER:

S 7 1 3 - 0 2 X 2 - 1 2 0 1 - Z

TYPE NUMBER 02 **SCHEMATIC NUMBER:** SEE SCHEMATIC NUMBER ABOVE **RoHS COMPLIANT**

Rev	Drawn	Checked	Approved	Date
0 Issued	S.E.	S.M.	S.M.	6/9/98
A Revised for RoHS Compliance	B.S.	S.M.	S.M.	07/21/08

SMP TECHNOLOGY, INC.

Stereo Jack 2.5 mm; Surface Mount ; Right Angle

9.00 (W) x 12.00 (L) X 4.00 (H)